

### Wall-Reform II External Wall Insulation

High Performance External Insulated Panel & Render System

**Suitable for use on all substrates:**

- ▶ Solid Wall
- ▶ System Built
- ▶ Traditional
- ▶ Steel/Concrete Timber Frame

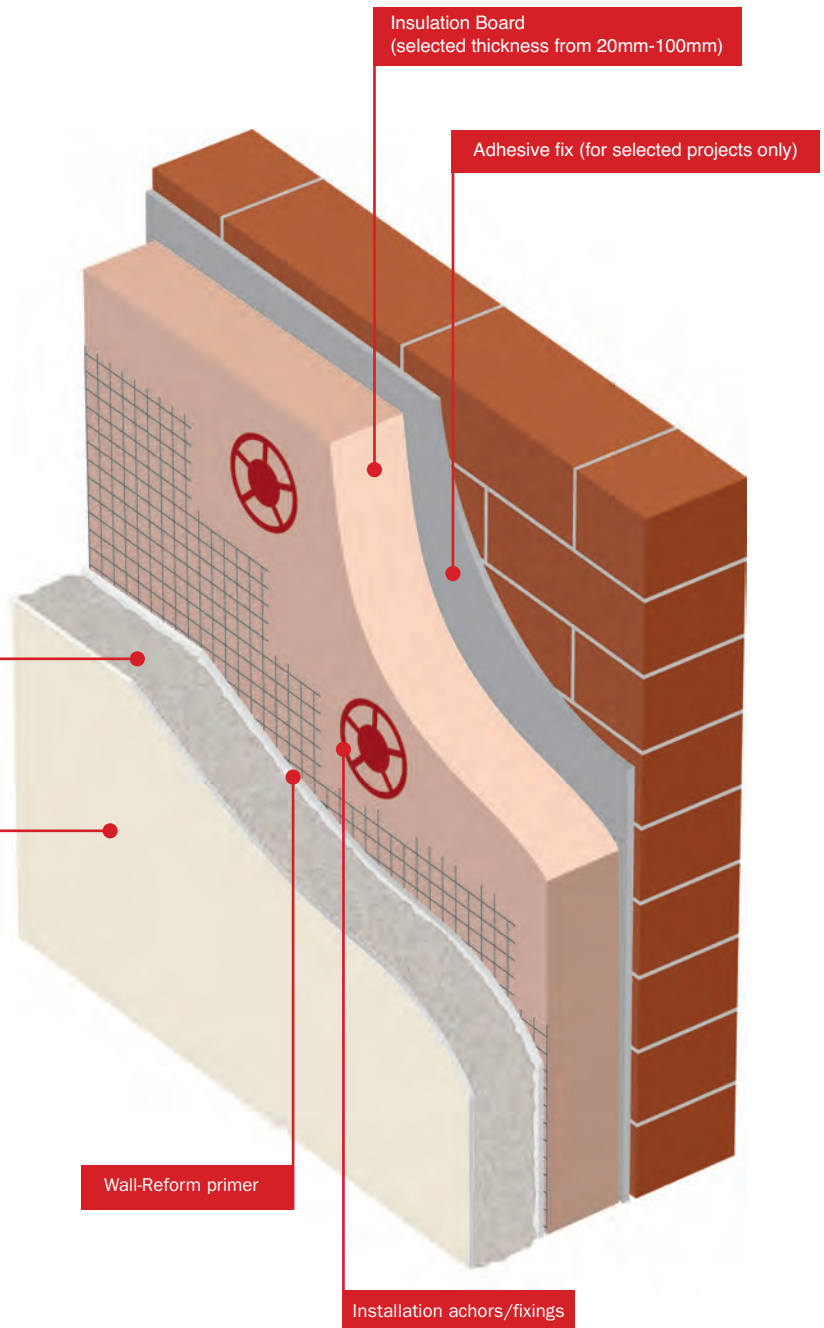

Wall-Reform insulation basecoat 15mm

Selected Agreement Approved maintenance free finish. Texturised acrylic, silicone finish or applied brick slip

Wall-Reform primer

Installation achors/fixings

U-values Typical Construction Format for 215mm brickwork

Allowing for a consistent 15mm Wall-Reform and 2mm acrylic/silicone finish

Un-insulated: 2.10W/m<sup>2</sup>.k

**Resultant value with:**

20mm EWb: 0.61 W/m <sup>2</sup> .k	70mm EWb: 0.24 W/m <sup>2</sup> .k
30mm EWb: 0.47 W/m <sup>2</sup> .k	80mm EWb: 0.22 W/m <sup>2</sup> .k
40mm EWb: 0.39 W/m <sup>2</sup> .k	90mm EWb: 0.20 W/m <sup>2</sup> .k
50mm EWb: 0.31 W/m <sup>2</sup> .k	100mm EWb: 0.18 W/m <sup>2</sup> .k
60mm EWb: 0.27 W/m <sup>2</sup> .k	



### Wall-Reform I External Wall Insulation

High Performance External Insulated Panel & Render System

**Suitable for use on all substrates:**

- ▶ Solid Wall
- ▶ System Built
- ▶ Traditional
- ▶ Steel/Concrete Timber Frame

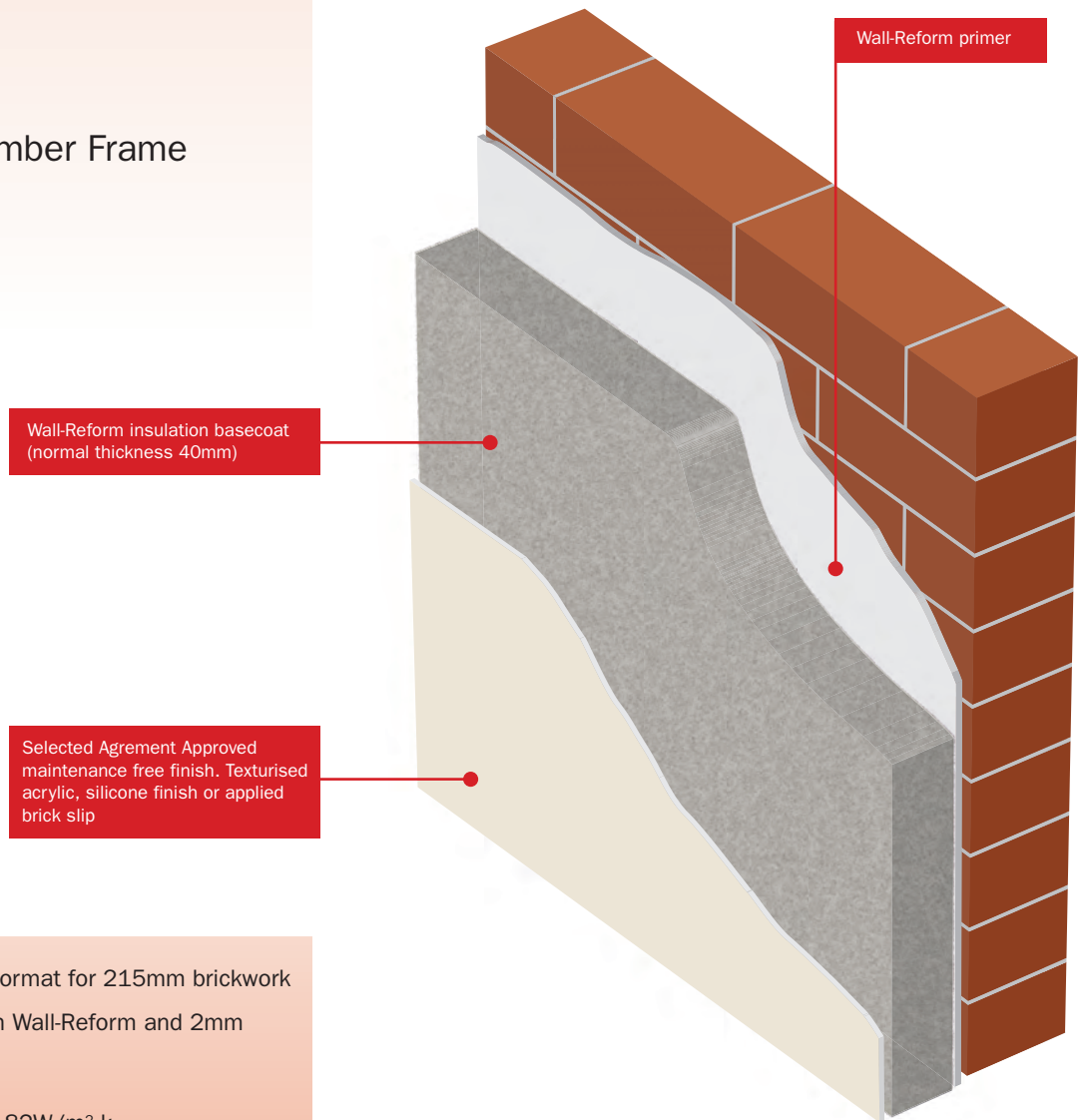

U-values Typical Construction Format for 215mm brickwork

Allowing for a consistent 40mm Wall-Reform and 2mm acrylic/silicone finish

Un-insulated: 2.10W/m<sup>2</sup>.k

After Wall-Reform application 0.82W/m<sup>2</sup>.k

- British Board of Agreement approved
- High impact resistance
- Can be applied at 40mm-100mm thickness
- Applied externally (or internally)
- Protects the fabric of the wall
- Eliminates condensation

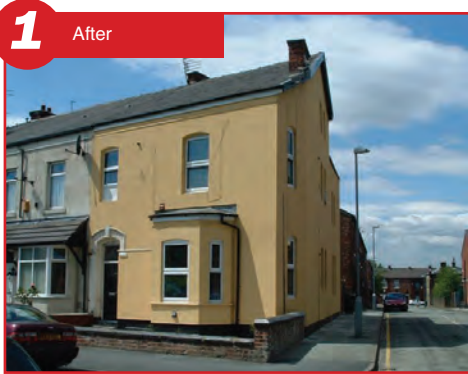
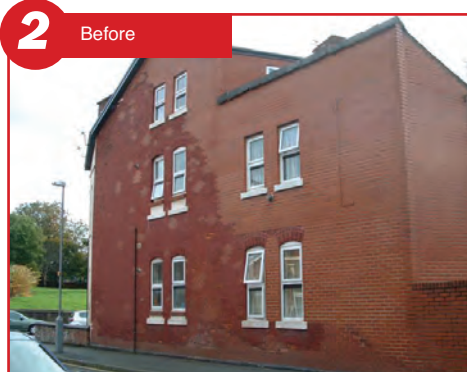

## Benefits when applied as thermal exterior render

- British Board of Agreement (BBA) as insulating plaster Meets British standards
- Energy Savings Trust approval
- Federation of Master Builders member
- The only plaster/render product that has a payback time saving clients energy and money
- When applied externally to solid walls the product can be applied easily and enhances the thermal resistance value of the wall to that of a cavity insulated wall construction
- A variety of finishes can be applied as a topcoat to the Wall-Reform render externally
- Helps save CO<sub>2</sub> emissions

## Benefits when applied as a thermal internal plaster

- BBA certification as a remedial damp proof plaster
- British Wood Preservation and Damp Association (BWPDA)
- The product helps to combat condensation and associated problems as a result of the product application raising the temperature of the wall construction combating condensation and cold bridging
- A plaster skim finish is applied when using internally

### Climate Energy Solutions Ltd

Unit 4, Tamdown Way, Springwood Industrial Estate, Braintree, Essex, CM7 2QL

Tel: 0800 980 4749

Email: [info@wallreform.co.uk](mailto:info@wallreform.co.uk)

[ce-solutions.co.uk](http://ce-solutions.co.uk)

**1** Boards Applied



**2** Wall-Reform Applied



**3** Finished



## Increased Benefits with Wall-Reform II

- All benefits of Wall-Reform System I External
- BBA certification for Wall-Reform System II
- Meets stringent government set building standards
- An un-insulated solid wall has a U-value of 2.1 with this system U-value will reach 0.30 new build regulations acceptable for the whole of the UK

### Climate Energy Solutions Ltd

Unit 4, Tamdown Way, Springwood Industrial Estate, Braintree, Essex, CM7 2QL

Tel: 0800 980 4749

Email: [info@wallreform.co.uk](mailto:info@wallreform.co.uk)

[ce-solutions.co.uk](http://ce-solutions.co.uk)

